



Transition Booklet

Progressing from Grade 6 to Year 7



St. Joseph's College Echuca
STRENGTH & KINDLINESS



Kildare
EDUCATION
MINISTRIES
In the Brigidine Tradition

*A Kildare Education Ministries
Catholic secondary school in
the Brigidine tradition*



A warm welcome to St Joseph's College.
We look forward to having you as part of our school community.
May your education journey with us be a memorable and fulfilling one.

Welcome

As a Year 7 student in 2024, you are joining St Joseph's College during an exciting phase of progress and growth.

You will be the first group of Year 7 students to commence the beginning of the school year at our new Kildare Campus, where you will remain for the first three years of your secondary schooling, before moving to our central Brigidine Campus in Year 10.

After 137 years on the one historic site, we transitioned to a multi campus College in 2023 with the opening of our state-of-the-art learning facility - Kildare Campus, to meet the growing demand for Catholic education in the region.

Situated on 80 acres of greenfields land, our plans for Kildare Campus are enormous and unlike anything our community has ever seen before!

Included in the first stage is an administration building, library, learning building, staff offices, outdoor courts, outdoor gym equipment, passive green spaces, car park and drop-off areas.

Stage 2 capital works, which commenced earlier this year, include a technology building, science classrooms, art spaces, canteen, sports oval, a new learning space and more learning enhancement provision.

Stage 3 works will commence in 2024/2025 and include a sports stadium, performing arts facility and Chapel.

This booklet aims to support your transition from primary school life, to secondary school, and to answer any questions you might have.

The majority of the information in this booklet relates to Kildare Campus, as this is where you will spend most of your time, however you will also attend our Brigidine Campus for some practical subjects and whole school events.

Further updates regarding building works and requirements for the start of school, will be communicated with you and your family at our Parent Information Evening in November and during your Orientation Day in December.





St Joseph's College Staff

Principal

Ms Anne Marie Cairns



Kildare Campus Director

Mr Jarrod O'Brien

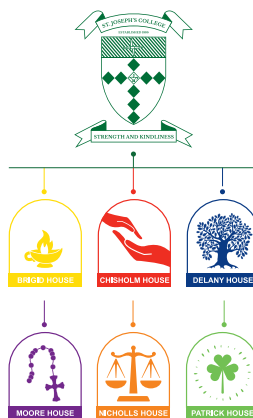

Kildare House Leaders

Brigid



Mr Butler

Chisholm



Mrs Chatfield

Delany



Mrs Carter

Moore



Mrs Bourke



Mrs Laughlin

Nicholls



Mr Armfield

Patrick



Mr Brady

Wellbeing Team



Ms Pola



Mr Prime



Francis Lias



Lisa Baker



Abbey Watson



Aunty Donna Walsh

Koorie Support

College Staff

Learning Enhancement



Miss Ringin



Ms Harding-Davies



Ms Arlow



Mr Hutton



Mrs Arnel

Office Staff Registrar



Mrs Scragg



Mrs James

Some of Our Teaching Team



Mrs Cosgriff



Mr Kennedy



Ms Irvine



Mrs Watson

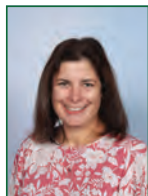

Mrs Oliver



Ms Devitt



Mrs Molluso



Mrs Galpin



DR. KEMPFER COLLEGE
FOR WISDOM AND KNOWLEDGE
ECHUCA

ROALD DAHL
THE WITCHES

Map of Kildare Campus

- PEDESTRIAN ENTRANCE
- MAIN VEHICLE EXIT
- MAIN VEHICLE ENTRY
- VISITORS CARPARK
- PARENT DROP OFF ZONE
- MAIN PLAZA ENTRANCE
- BIKE SHELTER
- TURFED OUTDOOR SPACE

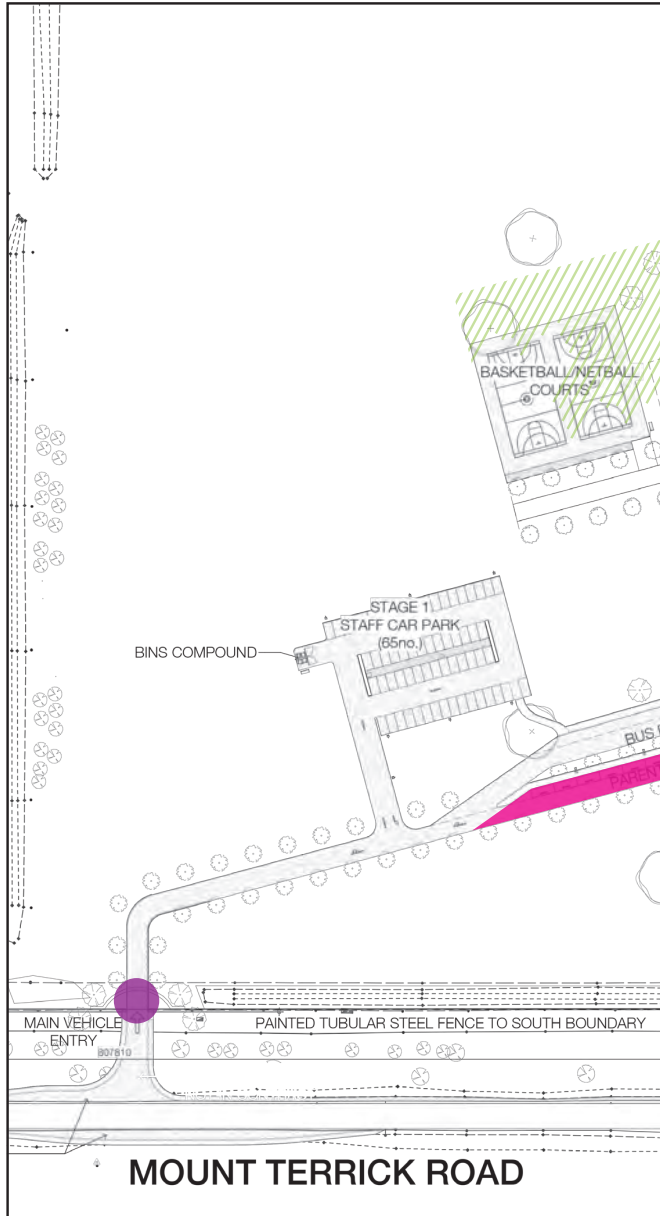

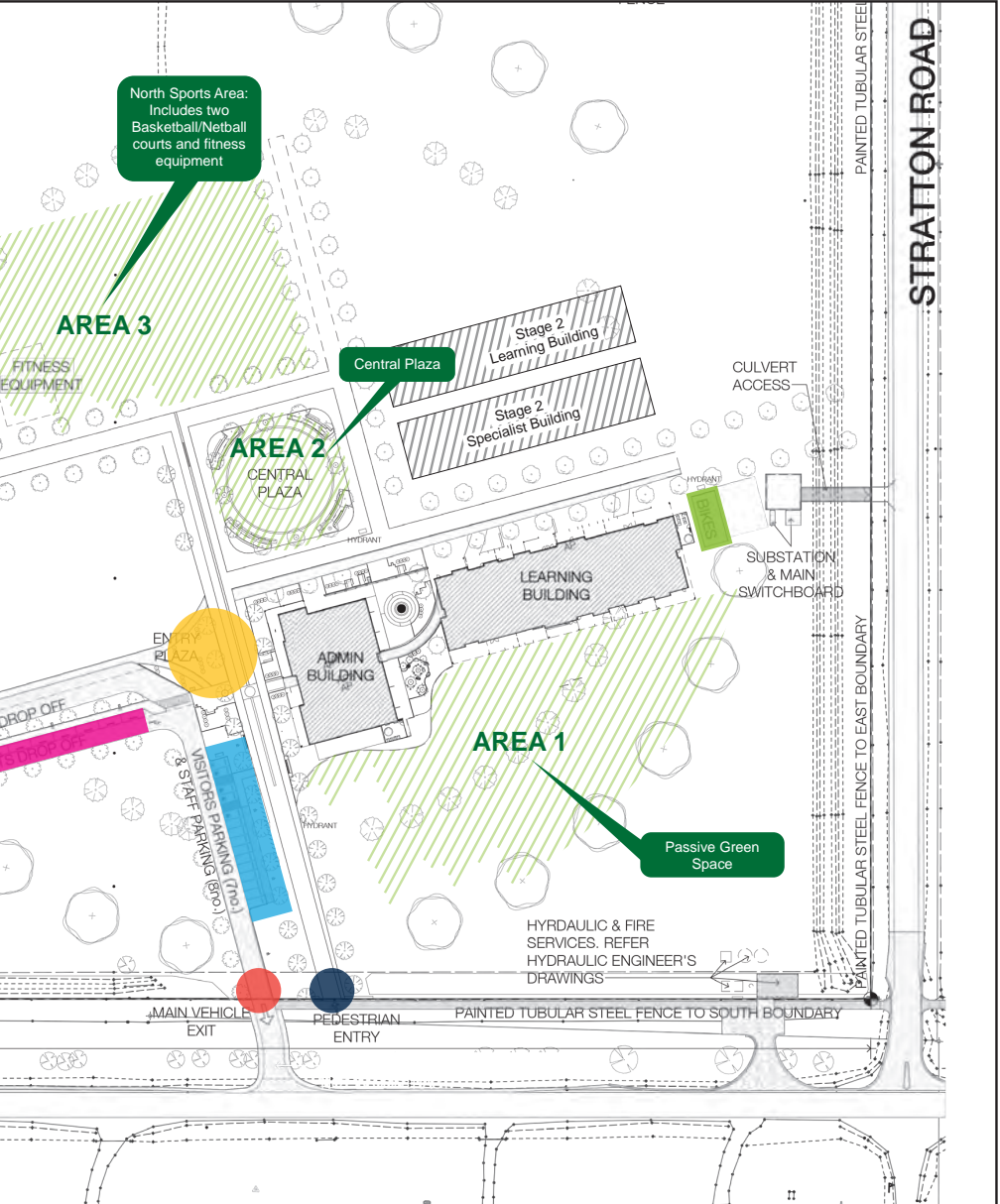

North Sports Area:
Includes two
Basketball/Netball
courts and fitness
equipment

AREA 3

Central Plaza

AREA 2
CENTRAL
PLAZA

AREA 1

Passive Green
Space

STRATTON ROAD

PAINTED TUBULAR STEEL

PAINTED TUBULAR STEEL FENCE TO EAST BOUNDARY

PAINTED TUBULAR STEEL FENCE TO SOUTH BOUNDARY

MAIN VEHICLE
EXIT

PEDESTRIAN
ENTRY

VISITORS PARKING (700)
& STAFF PARKING (800)

ENTRY
PLAZA

DROP OFF
& PICK UP

HYDRULIC & FIRE
SERVICES. REFER
HYDRULIC ENGINEER'S
DRAWINGS

CULVERT
ACCESS

SUBSTATION
& MAIN
SWITCHBOARD

FITNESS
EQUIPMENT

FITNESS
EQUIPMENT

Timetables

Year 7 Timetable Example

MONDAY	TUESDAY	WEDNESDAY	THURSDAY	FRIDAY
LM - LMKNI1 - KN21	LM - LMKNI1 - KN21	LM - LMKNI1 - KN21	LM - LMKNI1 - KN21	LM - LMKNI1 - KN21
1 - ENGO7J - KN24 - EDE	1 - REL07J - KN15 - TDR	1 - ENGO7J - KN24 - EDE	1 - ART07J - KN12 - MSW	1 - ENGO7J - KN24 - EDE
2 - MAP07J - KN2 - AAR	2 - MAP07J - KN2 - JOL	2 - MAP07J - KN2 - AAR	2 - IDE07J - KN23 - MSW	2 - REL07J - KN15 - JOB
3 - HUM07J - JAW	3 - HPE07J - KN3 - BKE	3 - ITA07J - KN21 - CRLI, KGE	3 - FOO07J - BC15 - JIR	3 - HPE07J - KN3 - BKE
4 - WOO07J - BC1 - JLA	4 - REA07J - KLIB - JOB	4 - HPE07J - KN3 - BKE	4 - HUM07J - KN16 - JAW	4 - HUM07J - KN16 - JAW

Period Times Example

PERIOD	START	END
Learning Mentor	8:53	9:03
Period 1	9:06	10:19
Recess	10:19	10:40
Period 2	10:43	11:57
Period 3	12:00	1:13
Lunch	1:13	1:52
Period 4	1:53	3:10



Get To Know Our School Routine

Brigidine Campus

Students and staff will be bussed to the Brigidine Campus approximately twice a term for whole school assemblies, masses, and other events on our very own shuttle bus. These whole school gatherings will support our 'One College' approach.

Timetables

A timetable lasts for a term and works on a 2 week rotation. Individual timetables are on Compass and a hard copy will be given out (these can be put in your folder or in computer covers).

The day usually begins with Learning Mentor meetings followed by period 1.

This is followed by a 20 minute recess.

Period 2 and 3 are before lunch which is 40 minutes.

Then we have Period 4 after lunch to finish the day.

House assemblies are held every Tuesday rather than Learning Mentor meetings.

If you are late to school, we ask you to sign in at the front office. If you must leave school early, parents are required to complete an attendance note via Compass.

Subjects

Core Subjects

- English
- Maths
- Religion
- Italian
- HPE (Health & Physical Education)

- Humanities
- Science
- Pastoral Program (1 period per fortnight)
- Reading Room (1 period a week)

Arts and Technology (1 Semester of each)

- Visual Art (Art & Media)
- Performing Art (Music & Drama)
- Food & Design
- Material Design (Robotics & Materials)

Classes

Classes of about 25 are allocated at the start of the year and you will be with these students for the entire year in all subjects.

Most classes will be undertaken at Kildare Campus. Some practical classes for science, woodwork and foods will run at Brigidine Campus (maximum of three per fortnight) while all theory classes will be undertaken at Kildare Campus.

Lockers

Lockers will be provided for students where bags will be stored. Equipment for each class will be organised before the lesson.

Extra Bags/Musical Instruments

If you need to bring an extra bag to school, it can be stored in your locker. Larger items can be stored in your House Leader's office.

Computers

Computers are provided to students on the first day of school. Families will need to purchase the laptop sleeve, as per the book list.

The computers are owned by the school and students sign an agreement to use the computers by the school rules. Computers can be taken home and used and need to be charged at home each night. Games are not permitted to be played during class.

Textbooks

Some textbooks, as specified on the booklist, will need to be purchased prior to commencement.

Stationery

Students need an A4 exercise book for each subject and a pencil case with pens, pencils, textas and a ruler (as per the book list).

Houses

- Students will be placed into one of our six Houses at St Joseph's College.
- Siblings are not always grouped in the same House.
- Within each House, students will also be assigned to a smaller Learning Mentor Group.
- At Kildare Campus, students will be placed in Learning Mentor Groups with a mix of Year 7 & 8s in 2024 and Year 7s, 8s & 9s in 2025.



Learning Mentor Program

All students are allocated to a Learning Mentor Group under the care of a Learning Mentor staff member. The Learning Mentor, or LM as it is fondly referred to, will be a wonderful source of all things St Joseph's, including House spirit. Students will gather in these groups at least eight times per fortnight. They will also meet in their LM for an extended period once a fortnight to focus on more specific areas of pastoral care, wellbeing and to address any student issues.

The LM staff member is also the first point of contact for parents/carers and students for any questions, concerns, celebrations or successes. The LM is a constant support person for students during their time at St Joseph's and will guide them on their academic and personal journey at the College.

Canteen

The canteen at Kildare Campus is currently under construction and should be completed by mid 2024.

Students wishing to purchase lunch from our canteen at Brigidine Campus can do so by placing an order online via the Flexischools system by 9am each day. All orders are then delivered to Kildare Campus and students can collect them at the start of lunch from the reception area in the Administration Building.

Sick Bay

At Kildare Campus, access to the sickbay is through Student Services in the Administration Building. Teachers will send you to the Front Office with a friend if you are unwell or injured.



School Uniform

- The St Joseph's College uniform is stocked at Hip Pocket Echuca and families will receive a uniform price and ordering list at the Parent Information Evening in November.
- Sport uniform is only to be worn when students have PE practical lessons (twice a week).
- Correct uniform is expected every day.
- Black leather shoes must always be worn in Technology subjects (if HPE falls on the same day you are required to bring your black leather shoes in your bag).
- If you are out of uniform, you require a note from home to your House Leader who will add a note to your learning profile explaining this to teachers.

Mobile Phones

Students are required to leave their phones in their lockers on silent. Phones are not to be used at all on the school grounds and will be confiscated if they are. There are a number of steps that are followed if students do not follow this rule.

Year 7 Camp

Details regarding Year 7 Camp will be announced early next year. The camp is one of the highlights for Year 7 students and is a wonderful way to meet new people and get to know the other Year 7 students in your House and across the entire year level.

Homework

If students work well, they would complete most of their work in class. Teachers may assign tasks to be completed at home.

Sport

There are many opportunities to play sport for our school. Sign-up sheets will be available and students are reminded in LM meetings and House Assemblies when to complete these.

Library

The library is open for students to use before school and during breaks, except for Wednesday recess. To borrow books, students use their ID card. Books are borrowed out for 4 weeks at a time, but may be re-borrowed at the library or through Compass.

Printing

A printer is available for students in the library. At the beginning of the year you will be allocated \$10 to your printing account. Parents can top up the account through the office or online.

Contacting Teachers

Students can contact teachers through email or meet them in person. Teachers' offices are located within the Learning Building.

All visitors to Kildare Campus must first report to the Administration Building Front Office.

Teachers will also communicate with students via email. It is important students learn to check their emails on a regular basis.

Get To Know Our School Routine

Quiet Place

The library is a quiet, safe place that students can visit if they feel overwhelmed in the yard. There are also a number of breakout spaces near the lockers that students can use for quiet time.

In some instances, where students are withdrawn from subjects, they may use the library to complete work or to participate in alternate programs with an aide.

Walking/Bike Path

There is a beautiful new path that commences near the entrance to Woodlands Circuit (on Mt Terrick Road opposite Cunningham Downs) and leads all the way directly to our Kildare Campus for those students who wish to walk or ride to school.

Masses & Liturgies

Students attend House Masses and whole school Liturgies during the year. Year 7 students will also visit and learn about the chapel at our Brigidine Campus, during Religion classes.

Bike Shelter

A number of students ride their bikes to school. We have a bike shelter located at the east side of the Learning Building where students can park their bikes during the school day. We recommend bringing your own bike lock to ensure your bike is kept secure.

For more information please contact:

Jarrold O'Brien, Asher Arnel or Kerrie Wood: transition@sjc.vic.edu.au









OUR CORE VALUES

WONDER

Celebrating all that is good
with joy and gratitude

COURAGE

Speaking and acting
with integrity

JUSTICE

Making needs of the
vulnerable paramount

HOPE

Bringing a sense
of purpose

COMPASSION

Walking with and having
empathy for all

HOSPITALITY

Welcoming all



Brigidine Campus: 21 Dickson Street, Echuca 3564 | Kildare Campus: 194 Mount Terrick Rd, Echuca 3564
Tel: (03) 5482 2577 Fax: (03) 5480 6427 | www.sje.vic.edu.au | enquiry@sje.vic.edu.au

